

KIPLING STATION CONDOS



ONE OF THE MOST ACTIVE DEVELOPERS IN THE GTA

12 YEARS
BUILDING
TORONTO'S
SKYLINE



19

TOWERS SOLD

10K+

SUITES SOLD

\$5.6B

DEVELOPMENT VALUE

0 DAYS

OF INTERIM OCCUPANCY

ZERO

CANCELLED SITES

ALWAYS

FULLY ZONED & CITY APPROVED



KIPLING STATION CONDOS



KIPLING STATION CONDOS

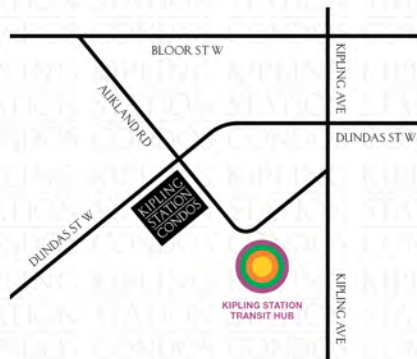

50 STOREYS

552 SUITES

22,000 SQ.FT. INDOOR / OUTDOOR
AMENITIES

PRELIMINARY NUMBERS ONLY - PLEASE REFER TO CONDOMINIUM DISCLOSURE



TYPICAL FLOOR PLATE

■ S ■ 1B ■ 1B+D
■ 2B ■ 3B

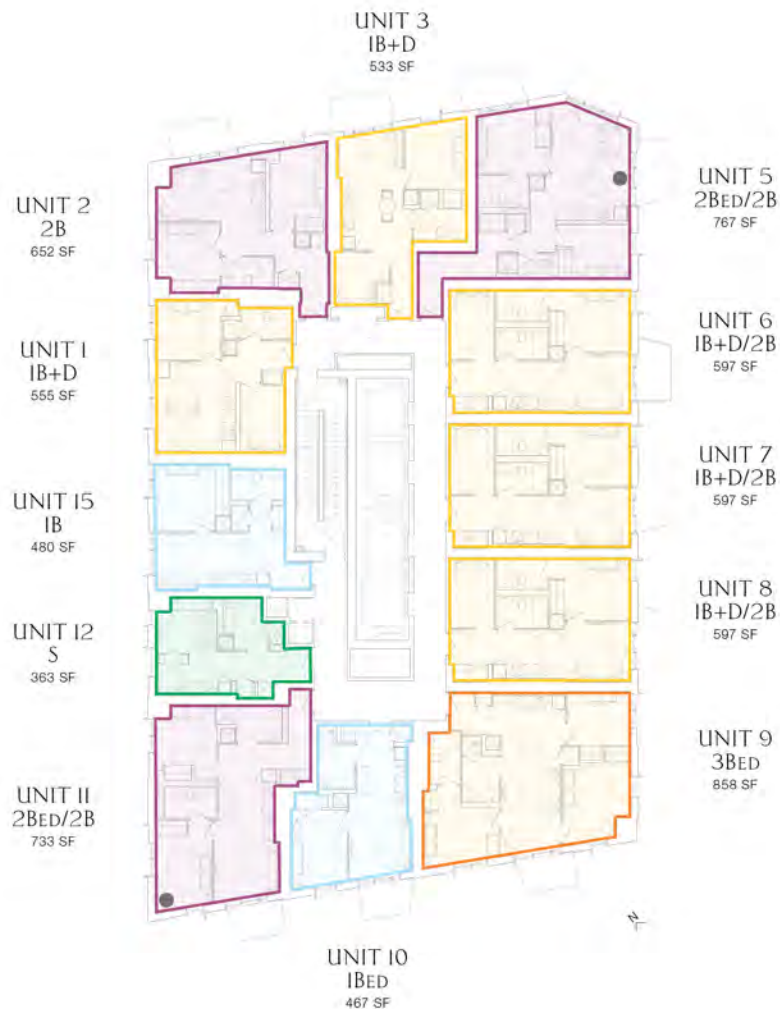

ETOBICOKE CITY HALL

210,000 SQ.FT. OFFICE SPACE

47,000 SQ.FT. OUTDOOR EVENT PLAZA

300,000 SQ.FT. PODIUM WITH COMMUNITY SPACES



KIPLING STATION CONDOS

2 MIN WALK



KIPLING TRANSIT HUB

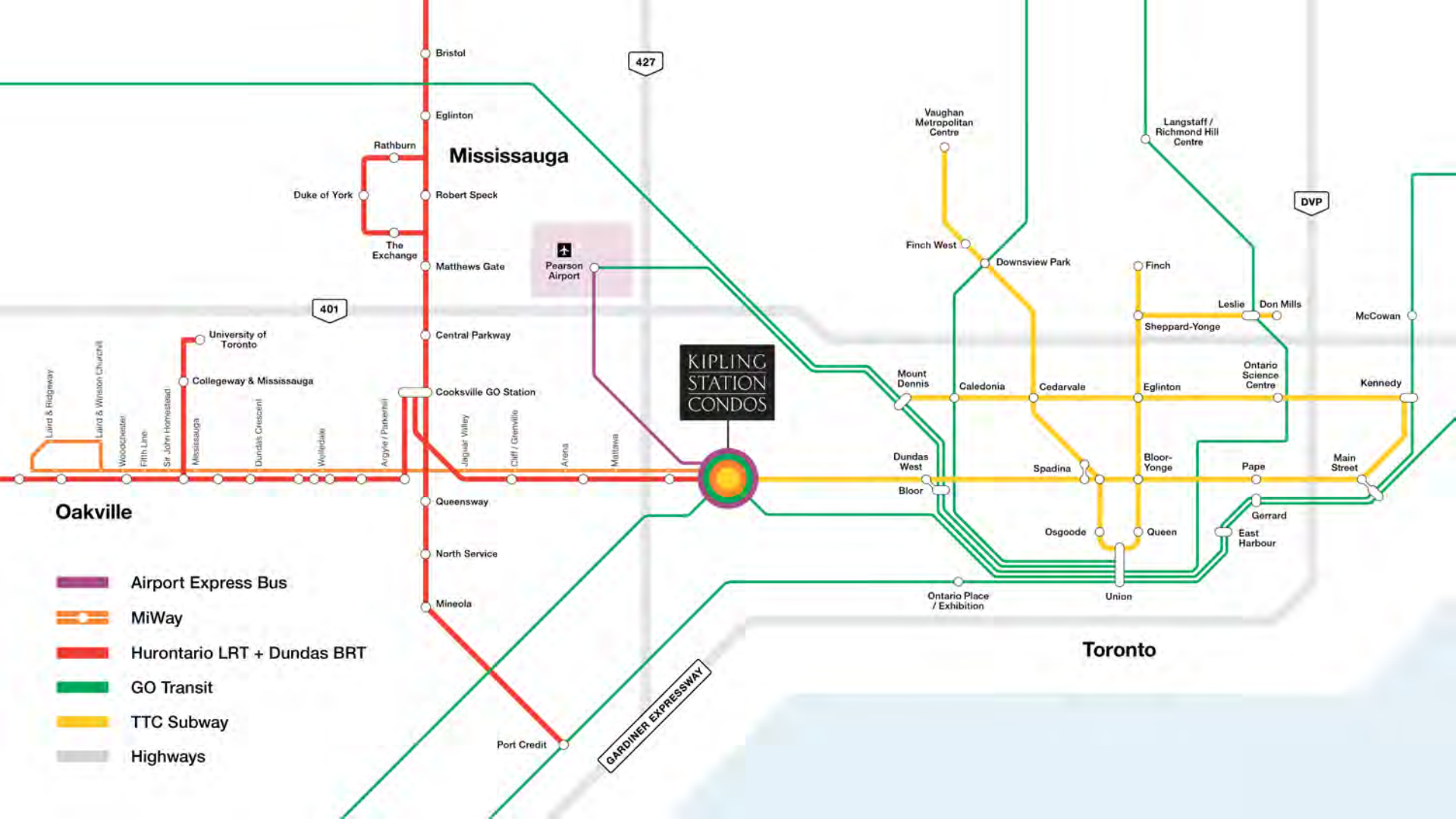

PEARSON INTERNATIONAL AIRPORT



15 MINS TO PEARSON



FROM KIPLING
ON THE AIRPORT
EXPRESS BUS

50,000 JOBS



AT PEARSON
INTERNATIONAL
AIRPORT

YOU HAVE ACCESS TO

12 YEARS
BUILDING
TORONTO'S
SKYLINE



LOCAL

TTC
TRANSIT



MUNICIPAL

MIWAY
+
TTC



REGIONAL

GO
TRANSIT



INTERNATIONAL

PEARSON
INTERNATIONAL
AIRPORT



TRANSPORTATION AT YOUR DOORSTEP

MAJOR GROWTH IS COMING TO DOWNTOWN ETOBICOKE

Current Development Applications
And Approved Sites



SOURCE: CITY OF TORONTO, DEVELOPMENT APPLICATIONS DATABASE



MAJOR GROWTH IS COMING TO DOWNTOWN ETOBICOKE

KIPLING
STATION
CONDOS

FUTURE
ETOBICOKE
CIVIC CENTRE



THANK YOU!

<https://therealtybulls.com/project/kipling-station-condos>



CENTRE COURT